

Installing IQ Battery Pedestal Mount

To install the Enphase IQ Battery 5P on the floor using Pedestal Mount, read and follow all warnings and instructions in this guide. Safety warnings are listed in the *IQ Battery 5P quick install guide*. These instructions are not meant to completely explain how to design and install an energy storage system. All installations must comply with national and local electrical codes and standards.



Scan QR code for other languages

Supported battery SKUs for mounting on Pedestal Mount:

IQBATTERY-5P-1P-INT, IQBATTERY-5P-1P-ROW, IQBATTERY-5P-3P-INT (IQ Battery 5P with FlexPhase), and IQBATTERY-10Z-1P-INT (This SKU is intended for use in South Africa only. The IQ Battery 10Z comprises of two base units of IQBATTERY-5P-1P-INT.)

✓ **NOTE:** All the images, dimensions, and references in this document are shown for IQ Battery 5P but are also applicable for IQ Battery 5P with FlexPhase.

A. PREPARATION

IQ Battery 5P units can be installed on the floor using the Pedestal Mount. The components required for installation are shown in the following image.

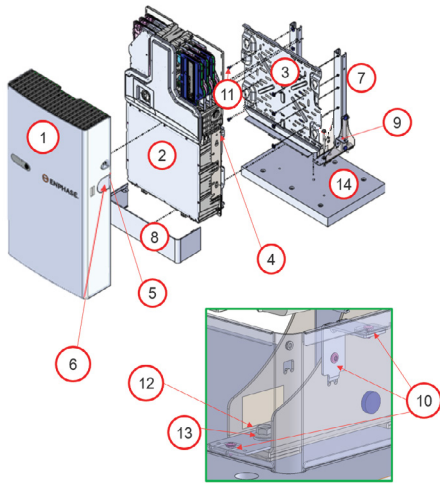

Required tools:

- #4 Phillips bit
- #2 Phillips bit
- SW15 socket wrench (to tighten the hexagonal head anchor bolt to the concrete floor)
- A 10 mm drill bit (to drill holes in the concrete floor)
- Hammer drill
- Torque driver 1 N m to 60 N m or equivalent

B. INSTALLATION

1 Planning and site preparations

The Pedestal Mount can be used to mount one IQ Battery 5P on a level floor. This section provides guidelines on how to choose and prepare a floor surface and to determine the amount of space needed to meet spacing requirements when installing IQ Battery 5P units on a Pedestal Mount. Follow these instructions and the site preparation instructions mentioned in the *IQ Battery 5P quick install guide*. Refer to IQ Battery 5P with FlexPhase quick install guide for IQBATTERY-5P-3P-INT.

✓ **NOTE:** In locations such as garages, local requirements may exist to additionally prevent damage to the equipment from vehicles. Check local building codes for requirements.

LABEL	DESCRIPTION	QUANTITY
Items in IQ Battery 5P packaging		
1	IQ Battery 5P cover	1
2	IQ Battery 5P unit	1
3	Bottom mounting bracket	1
4	M5 locking screw	2
5	IQ Battery 5P cover grounding screws	2
6	Conduit cover (for IQ Battery 5P) Conduit cover (for IQ Battery 5P with FlexPhase)	2 4
Items in IQ Battery 5P Pedestal Mount packaging		
7	Pedestal bracket assembly	2
8	Pedestal cover	1
9	L-bracket	2
10	Screw, M4 × 10 mm	6
11	Screw, M8 × 18 mm	8
12	M10 anchor bolts	4
13	M10 flat washer	8*
14	Concrete floor mount	1

* Only four M10 flat washers are required for the installation. The remaining four washers can be used to level uneven surfaces.

✓ **NOTE:** The top shield provided with IQ Battery 5P is not required for installing the battery on a Pedestal Mount. Installers can dispose it according to the local guidelines.

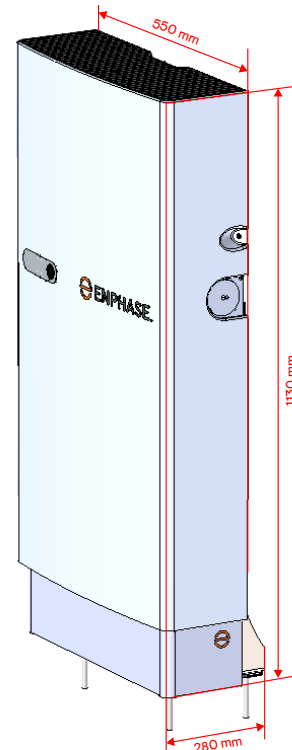

Dimensions of an IQ Battery 5P mounted on a Pedestal Mount



✓ **NOTE:** The distances mentioned in this section are minimum distances according to the UL 9540A testing. Installers need to ensure compliance with local spacing codes when installing the battery.

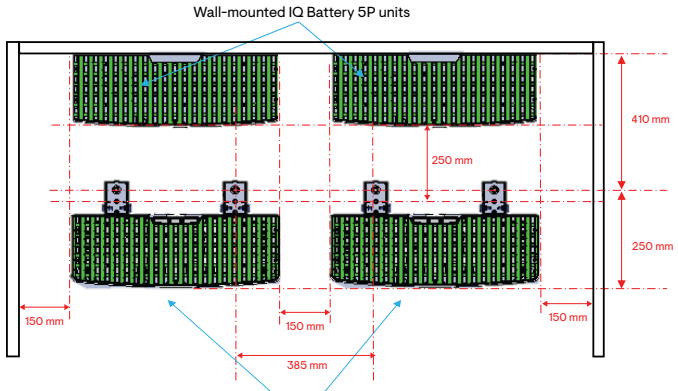

Pedestal-mounted IQ Battery 5P units
Pedestal Mount spacing details: Top view

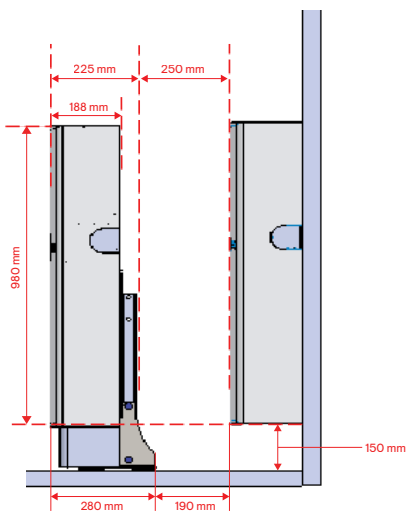

Minimum distance from the floor to the bottom of the unit (for both floor-mounted and wall-mounted)

Pedestal Mount spacing details: Side view

- A. Choose a location with at least 250 mm of space between a battery and the battery mounted in front.
- B. Select a smooth, flat concrete floor with a minimum thickness of 100 mm to hold the supplied anchor bolts.

✓ **NOTE:** Minor unevenness in the concrete surface can be corrected using the extra four flat washers included in the package.

✓ **NOTE:** The minimum distance from the floor to the bottom of the battery unit is 150 mm.

2 Prepare leg assembly

Items required for the step:

LABEL	DESCRIPTION	QUANTITY
3	Wall-mount bracket	1
7	Pedestal bracket assembly	2
9	L bracket	2
10	Screw, M4 x 10 mm	2
11	Screw, M8 x 18 mm	8

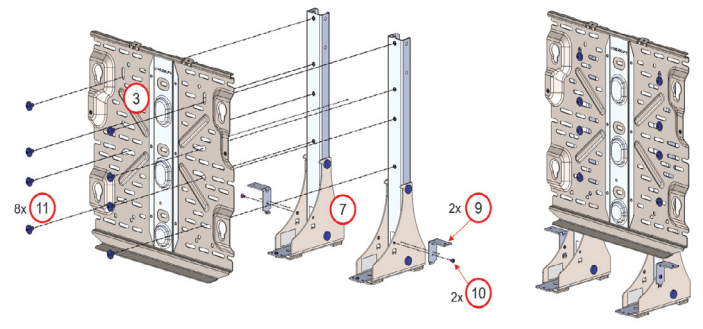

- A. Place the bottom mounting bracket aligned over the mounting holes on the pedestal bracket assembly.
- B. Screw the bottom mounting bracket onto the pedestal bracket assembly using the eight M8 screws (torque to 17 N m).
- C. Attach the L-brackets onto the pedestal bracket assembly using the two M4 screws (torque to 1.5 N m).

3 Drill holes in the floor for installation

Use the cardboard template provided with the Pedestal Mount kit to mark the drill holes in the floor.

- A. Fix the cardboard template on the identified smooth and flat concrete surface.

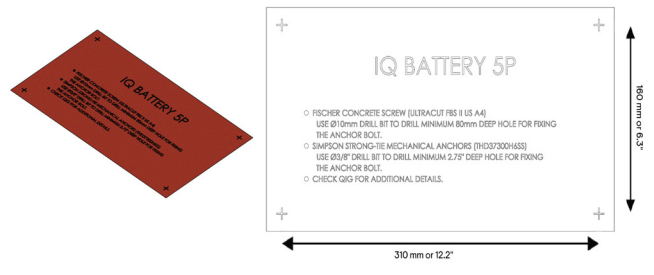

✓ **NOTE:** The surface at the drilling location should be at least 100 mm thick to support the floor mount installation.

✓ **NOTE:** Installers can verify the alignment of anchor holes of the leg assembly with drilling points on the template by placing the leg assembly on the template before drilling the holes.

- B. Drill a 10 mm diameter hole to a depth of 70 mm through the fixture and into the concrete.
- C. Clean the drill holes thoroughly.
- D. Remove the cardboard template.

4 Fix leg assembly on the floor

Items required for the step:

LABEL	DESCRIPTION	QUANTITY
12	M10 anchor bolts	4
13	M10 flat washer	4

Secure the pedestal assembly on the floor using four M10 anchor bolts and four M10 flat washers (torque to 54 N m).

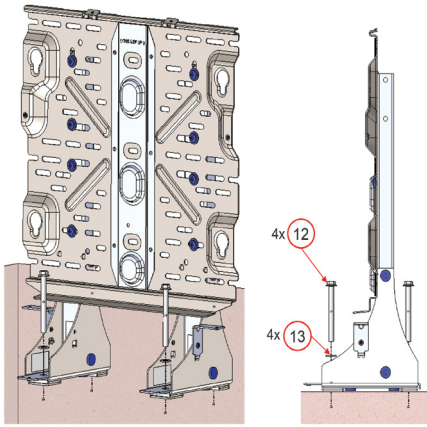

Mount the battery unit to the bottom mounting bracket (on the keyhole slot) using mount bolts, and fasten the locking screws (torque to 5.6 N m) according to the *IQ Battery 5P quick install guide*. Refer to *IQ Battery 5P with FlexPhase quick install guide* for IQBATTERY-5P-3P-INT.

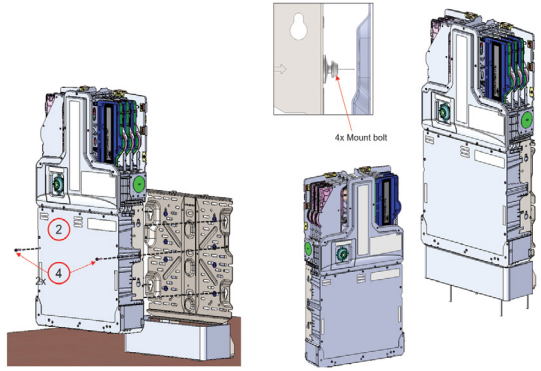

5 Fix the pedestal cover on the leg assembly

Items required for the step:

LABEL	DESCRIPTION	QUANTITY
8	Pedestal cover	1
10	Screw, M4 × 10 mm	4

Assemble the pedestal cover onto the L-bracket using four M4 screws (torque to 1.5 N m), as shown in the following image.

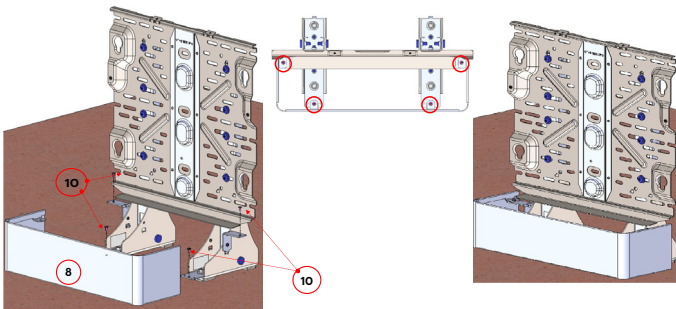

7 Fix the IQ Battery 5P cover on the IQ Battery 5P unit

Items required for the step:

LABEL	DESCRIPTION	QUANTITY
1	IQ Battery 5P cover	1
5	Screw, M5 × 10 mm	2
6	Conduit cover	2

A. Assemble the IQ Battery cover to the battery unit and fasten the IQ Battery cover grounding screws (torque to 3.1 N m) according to the *IQ Battery 5P quick install guide*.

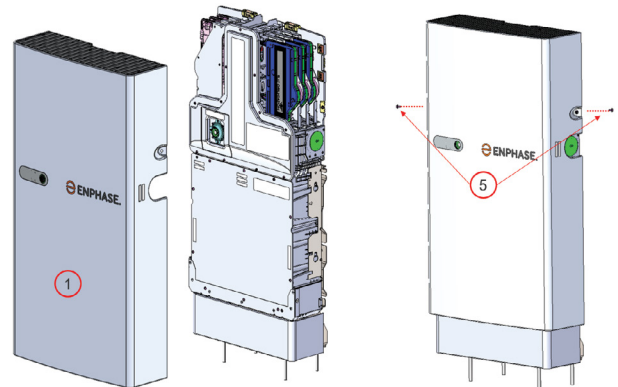

B. Use conduit covers to close the unused conduit openings on the battery.

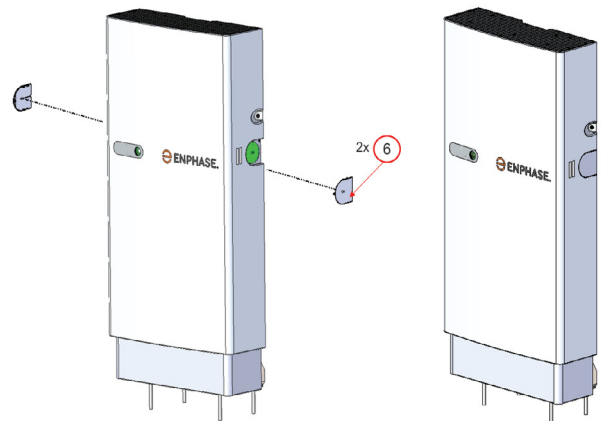

6 Mount IQ Battery 5P unit on the leg assembly

Items required for the step:

LABEL	DESCRIPTION	QUANTITY
2	IQ Battery 5P unit	1
4	Locking screw	2

C. To finish the installation and energize the battery, follow the instructions in the *IQ Battery 5P Quick Install Guide*.



WARNING! Risk of injury and equipment damage. The total lifting weight, with handles attached, is 67.35 kg. Handles must be used while lifting the battery. Two-person manual lifting is allowed only if permitted by local laws. Otherwise, use mechanical lifting.

Revision history

REVISION	DATE	DESCRIPTION
140-00291-03	September 2024	<ul style="list-style-type: none">Added the QR code for other languages.Added the SKUs supported by the IQ Battery Pedestal Mount.
Previous releases		